

Soils Map

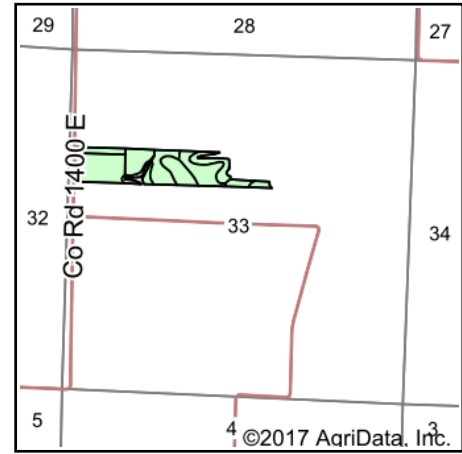

State: **Illinois**
 County: **Clay**
 Location: **33-5N-7E**
 Township: **Bible Grove**
 Acres: **30.26**
 Date: **10/2/2017**

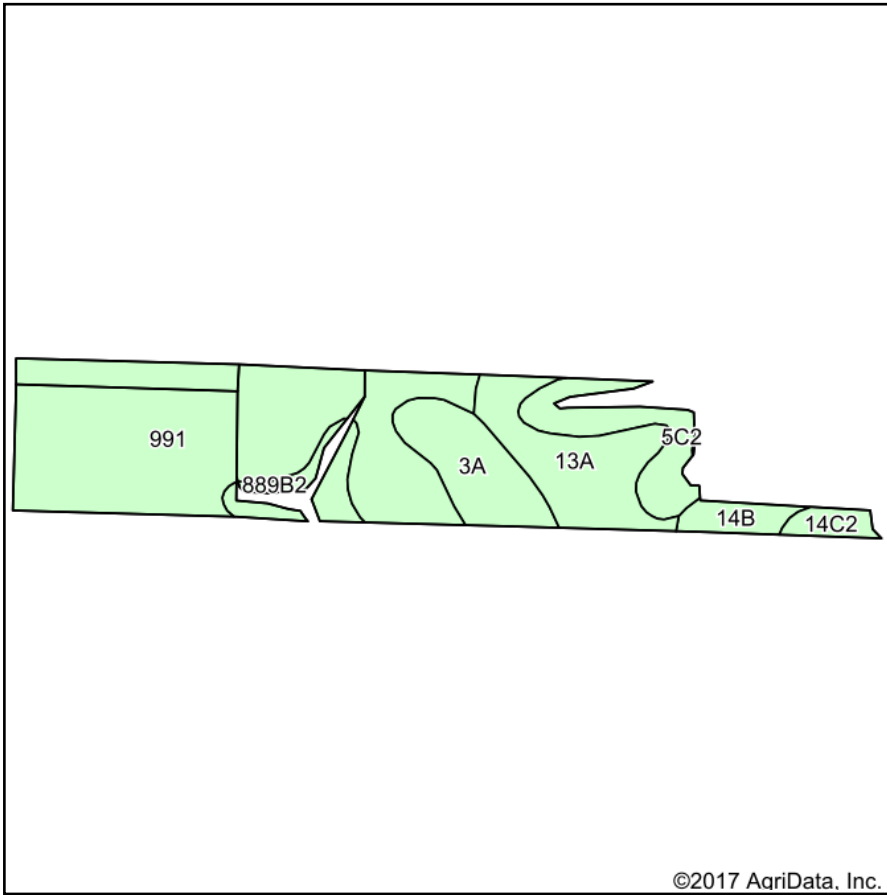
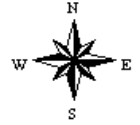

Soils data provided by USDA and NRCS.

©2017 AgriData, Inc.

Area Symbol: IL025, Soil Area Version: 11

Code	Soil Description	Acres	Percent of field	Il. State Productivity Index Legend	Corn Bu/A	Soybeans Bu/A	Wheat Bu/A	Alfalfa ^d hay T/A	Crop productivity index for optimum management
991	Cisne-Huey silt loams, 0 to 2 percent slopes	16.63	55.0%		133	45	52	0.00	102
13A	Bluford silt loam, 0 to 2 percent slopes	4.35	14.4%		136	44	55	0.00	101
3A	Hoyleton silt loam, 0 to 2 percent slopes	3.28	10.8%		146	46	58	0.00	108
**5C2	Passport silt loam, 5 to 10 percent slopes, eroded	2.80	9.3%		**124	**41	**50	0.00	**94
**889B2	Darmstadt-Bluford silt loams, 2 to 5 percent slopes, eroded	1.54	5.1%		**119	**41	**47	0.00	**91
**14B	Ava silt loam, 2 to 5 percent slopes	0.97	3.2%		**134	**44	**54	**3.23	**99
**14C2	Ava silt loam, 5 to 10 percent slopes, eroded	0.69	2.3%		**122	**40	**50	**2.93	**90
Weighted Average					133.1	44.2	52.7	0.17	100.8

Table: Optimum Crop Productivity Ratings for Illinois Soil by K.R. Olson and J.M. Lang, Office of Research, ACES, University of Illinois at Champaign-Urbana. Version: 1/2/2012 Amended Table S2 B811

Crop yields and productivity indices for optimum management (B811) are maintained at the following NRES web site:
<https://www.ideals.illinois.edu/handle/2142/1027/>

** Indexes adjusted for slope and erosion according to Bulletin 811 Table S3

^d Soils in the poorly drained group were not rated for alfalfa and are shown with a zero "0".

Soils data provided by USDA and NRCS. Soils data provided by University of Illinois at Champaign-Urbana.

*c: Using Capabilities Class Dominant Condition Aggregation Method

Topography Map

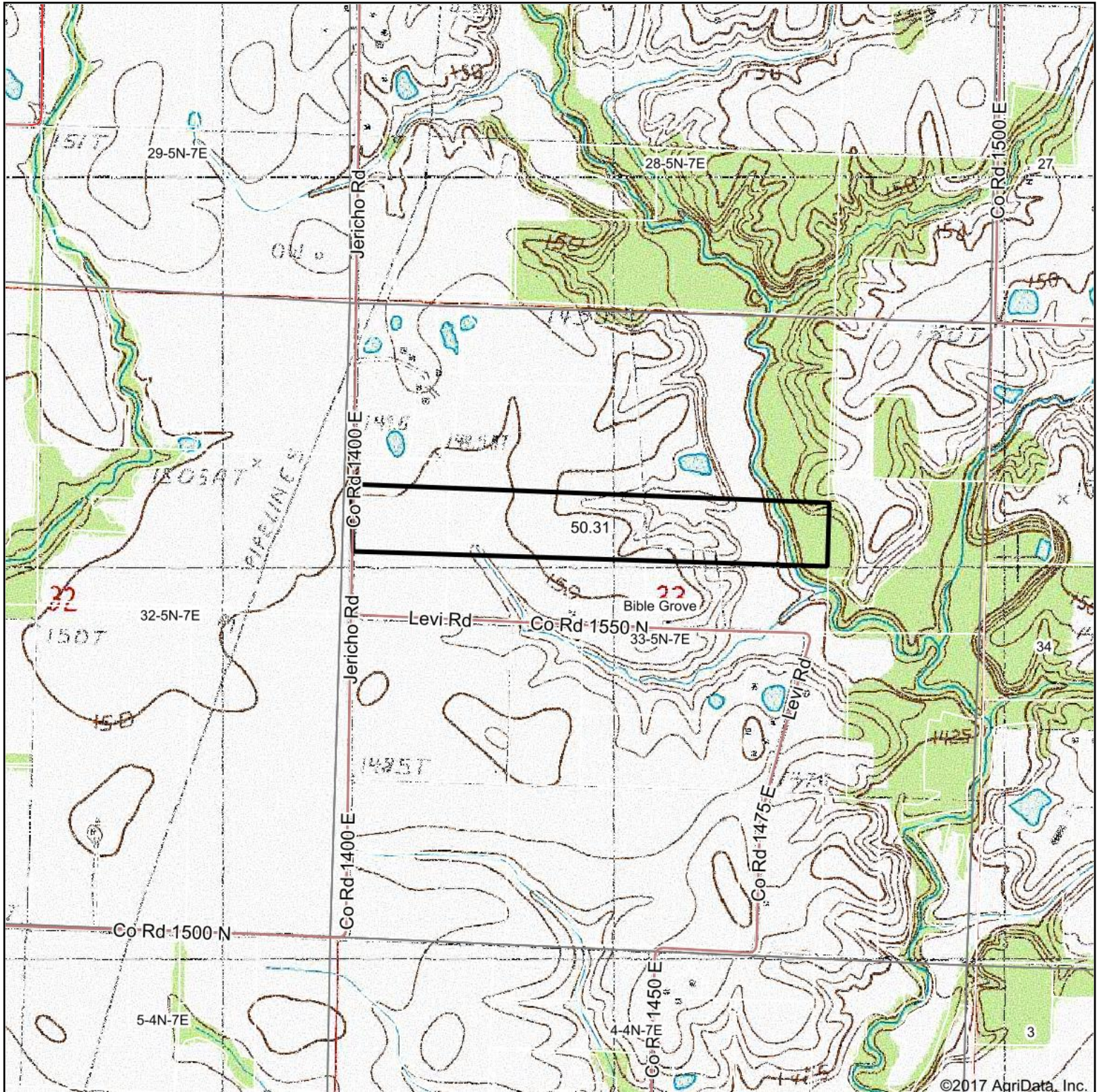

©2017 AgriData, Inc.

map center: 38° 50' 0.28, -88° 25' 49.93

0ft 1306ft 2612ft



Maps Provided By:



© AgriData, Inc. 2017

www.AgriDataInc.com

33-5N-7E
Clay County
Illinois



10/2/2017