

Aerial Map



©2018 AgriData, Inc.

map center: 37° 46' 57.97, -89° 36' 58.73

0ft 787ft 1575ft



Maps Provided By:

CUSTOMIZED ONLINE MAPPING
© AgriData, Inc. 2018 www.AgriDataInc.com

36-8S-5W
Jackson County
Illinois

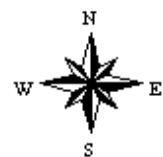

12/28/2018

Soils Map

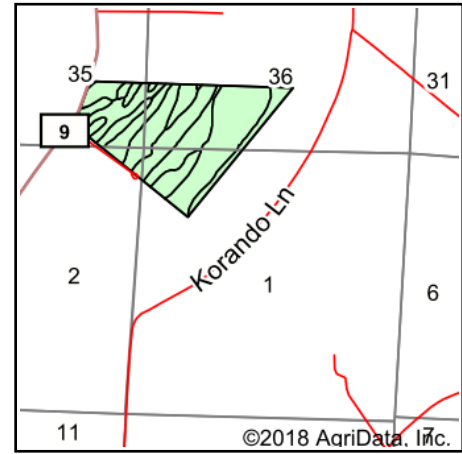
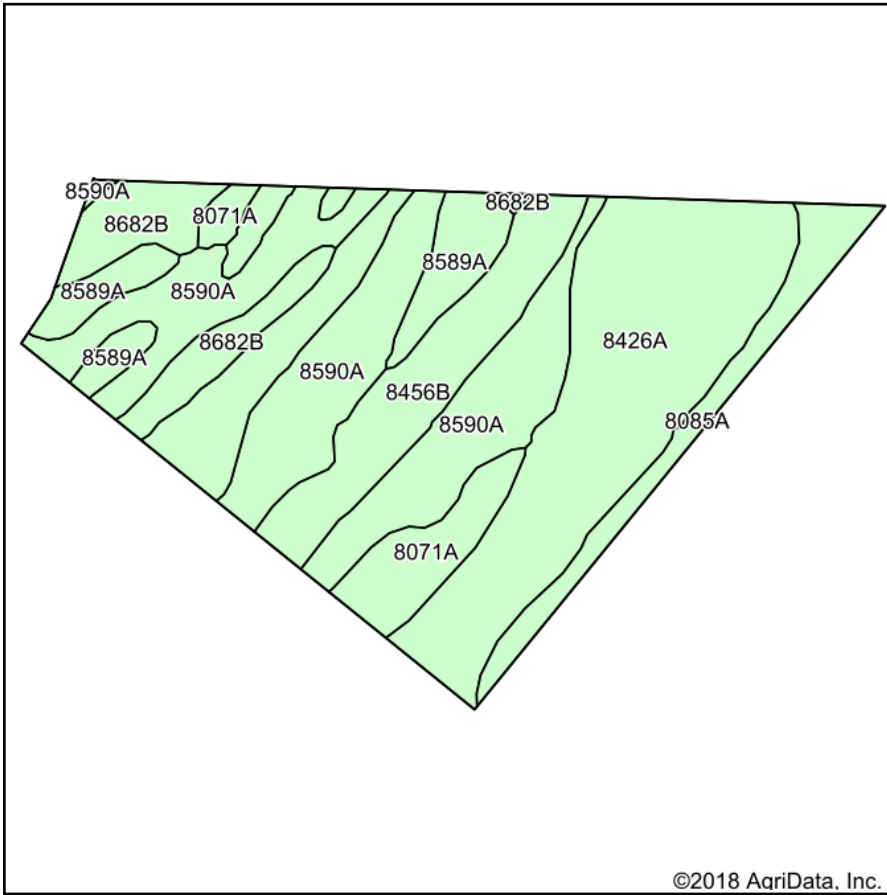

State: **Illinois**
 County: **Jackson**
 Location: **36-8S-5W**
 Township: **Degognia**
 Acres: **148.2**
 Date: **12/27/2018**



Area Symbol: IL077, Soil Area Version: 18

| Code | Soil Description | Acres | Percent of field | Il. State Productivity Index Legend | Corn Bu/A | Soybeans Bu/A | Wheat Bu/A | Crop productivity index for optimum management |
|-------------------------|---|-------|------------------|-------------------------------------|--------------|---------------|-------------|--|
| 8590A | Cairo silty clay, 0 to 2 percent slopes, occasionally flooded | 41.01 | 27.7% | | 159 | 53 | 61 | 119 |
| 8426A | Karnak silty clay, 0 to 2 percent slopes, occasionally flooded | 40.93 | 27.6% | | 134 | 45 | 53 | 101 |
| 8071A | Darwin silty clay, 0 to 2 percent slopes, occasionally flooded | 18.29 | 12.3% | | 149 | 50 | 60 | 111 |
| 8456B | Ware loam, 1 to 6 percent slopes, occasionally flooded | 15.69 | 10.6% | | 159 | 51 | 63 | 118 |
| 8682B | Medway silty clay loam, 1 to 6 percent slopes, occasionally flooded | 12.71 | 8.6% | | 176 | 57 | 69 | 131 |
| 8589A | Bowdre silty clay, 0 to 2 percent slopes, occasionally flooded | 10.30 | 7.0% | | 152 | 48 | 58 | 111 |
| 8085A | Jacob silty clay, 0 to 2 percent slopes, occasionally flooded | 9.27 | 6.3% | | 105 | 39 | 43 | 82 |
| Weighted Average | | | | | 148.5 | 49.3 | 58.2 | 111.1 |

Table: Optimum Crop Productivity Ratings for Illinois Soil by K.R. Olson and J.M. Lang, Office of Research, ACES, University of Illinois at Champaign-Urbana. Version: 1/2/2012 Amended Table S2 B811

Crop yields and productivity indices for optimum management (B811) are maintained at the following NRES web site: <http://soilproductivity.nres.illinois.edu/>

** Indexes adjusted for slope and erosion according to Bulletin 811 Table S3

Soils data provided by USDA and NRCS. Soils data provided by University of Illinois at Champaign-Urbana.