

# Aerial Map



©2018 AgriData, Inc.

map center: 37° 47' 20.2, -89° 37' 43.19

0ft 702ft 1404ft



Maps Provided By:  
**surety**  
CUSTOMIZED ONLINE MAPPING  
© AgriData, Inc. 2018 www.AgriDataInc.com

**35-8S-5W**  
**Jackson County**  
**Illinois**



12/27/2018

# Soils Map

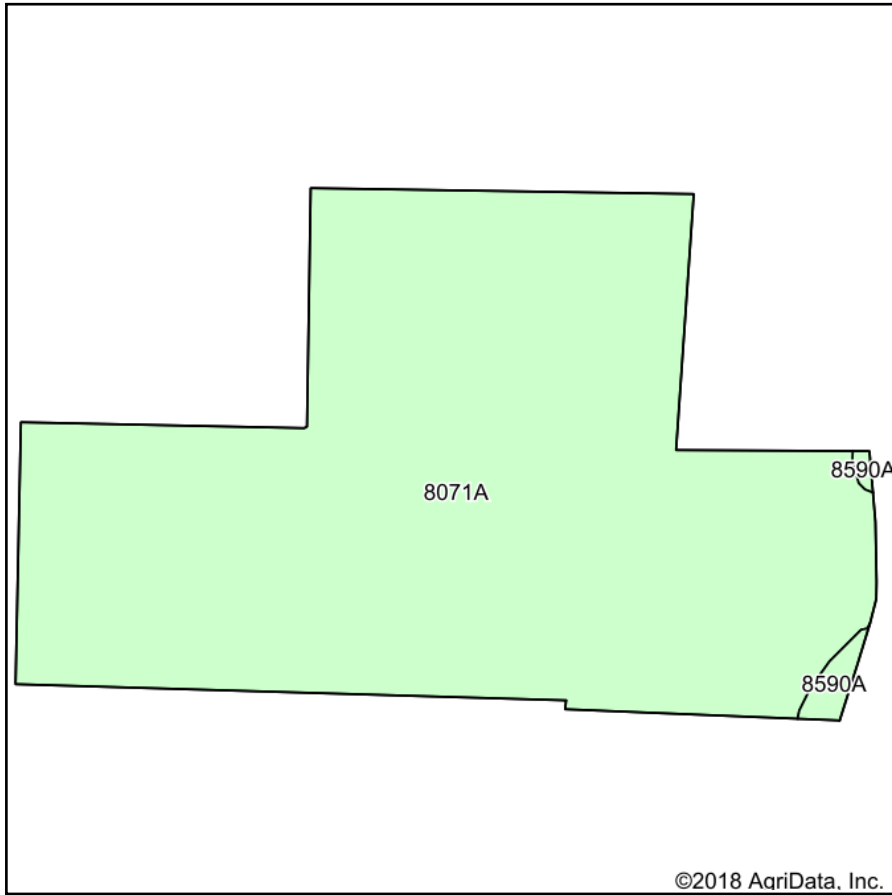

Soils data provided by USDA and NRCS.

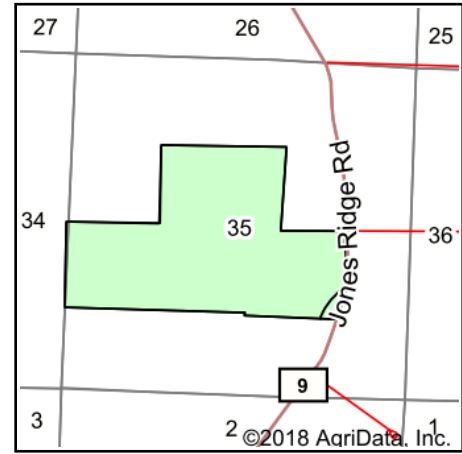

State: **Illinois**  
 County: **Jackson**  
 Location: **35-8S-5W**  
 Township: **Degognia**  
 Acres: **196.52**  
 Date: **12/27/2018**



Maps Provided By:



Area Symbol: IL077, Soil Area Version: 18

Code	Soil Description	Acres	Percent of field	Il. State Productivity Index Legend	Corn Bu/A	Soybeans Bu/A	Wheat Bu/A	Crop productivity index for optimum management
8071A	Darwin silty clay, 0 to 2 percent slopes, occasionally flooded	194.41	98.9%		149	50	60	111
8590A	Cairo silty clay, 0 to 2 percent slopes, occasionally flooded	2.11	1.1%		159	53	61	119
<b>Weighted Average</b>					<b>149.1</b>	<b>50</b>	<b>60</b>	<b>111.1</b>

**Table: Optimum Crop Productivity Ratings for Illinois Soil by K.R. Olson and J.M. Lang, Office of Research, ACES, University of Illinois at Champaign-Urbana.** Version: 1/2/2012 Amended Table S2 B811

Crop yields and productivity indices for optimum management (B811) are maintained at the following NRES web site: <http://soilproductivity.nres.illinois.edu/>

\*\* Indexes adjusted for slope and erosion according to Bulletin 811 Table S3

Soils data provided by USDA and NRCS. Soils data provided by University of Illinois at Champaign-Urbana.