

Aerial Map

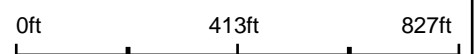

©2018 AgriData, Inc.

map center: 37° 46' 54.23, -89° 37' 24.66



35-8S-5W
Jackson County
Illinois



Maps Provided By:

CUSTOMIZED ONLINE MAPPING
© AgriData, Inc. 2018 www.AgriDataInc.com

12/28/2018

Soils Map

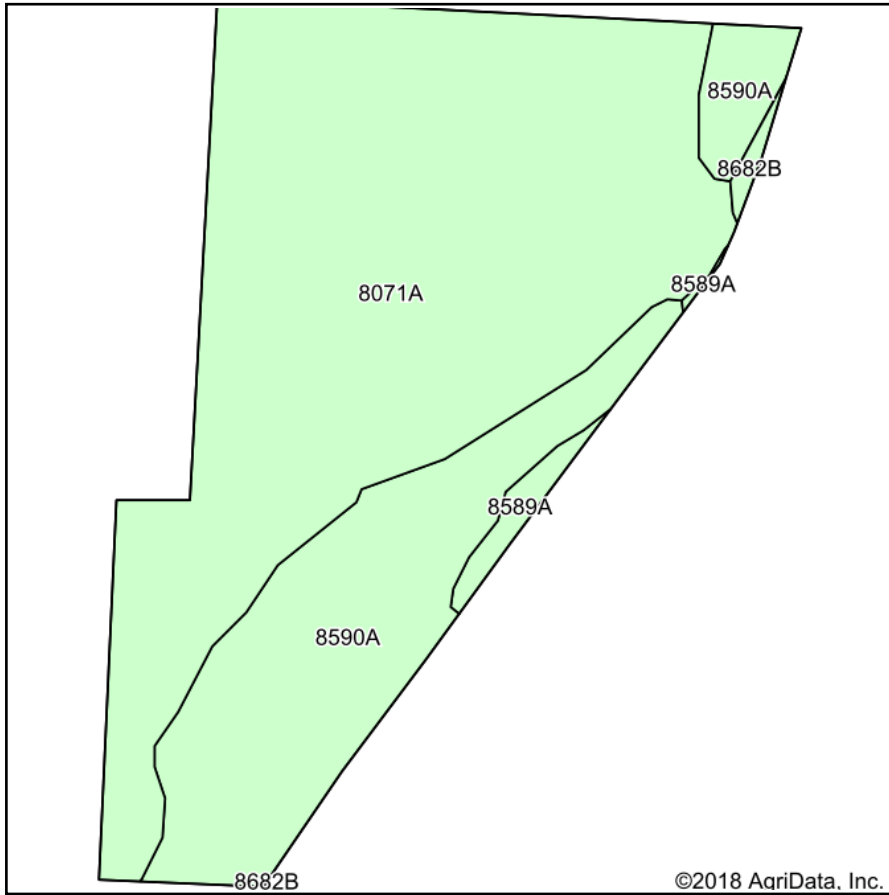

Soils data provided by USDA and NRCS.

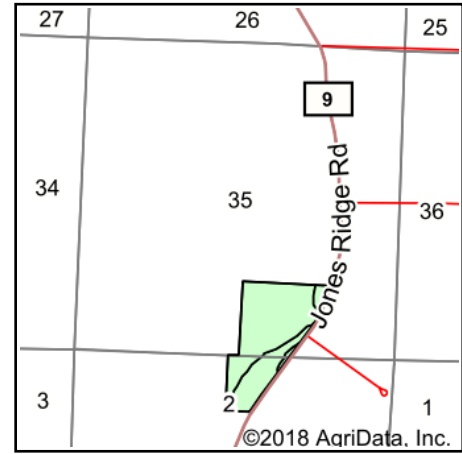

State: **Illinois**
 County: **Jackson**
 Location: **35-8S-5W**
 Township: **Degognia**
 Acres: **51.12**
 Date: **12/28/2018**



Maps Provided By:



© Agridata, Inc. 2018

www.AgridataInc.com



Area Symbol: IL077, Soil Area Version: 18

Code	Soil Description	Acres	Percent of field	Il. State Productivity Index Legend	Corn Bu/A	Soybeans Bu/A	Wheat Bu/A	Crop productivity index for optimum management
8071A	Darwin silty clay, 0 to 2 percent slopes, occasionally flooded	36.19	70.8%		149	50	60	111
8590A	Cairo silty clay, 0 to 2 percent slopes, occasionally flooded	13.85	27.1%		159	53	61	119
8589A	Bowdre silty clay, 0 to 2 percent slopes, occasionally flooded	0.82	1.6%		152	48	58	111
8682B	Medway silty clay loam, 1 to 6 percent slopes, occasionally flooded	0.26	0.5%		176	57	69	131
Weighted Average					151.9	50.8	60.3	113.3

Table: Optimum Crop Productivity Ratings for Illinois Soil by K.R. Olson and J.M. Lang, Office of Research, ACES, University of Illinois at Champaign-Urbana. Version: 1/2/2012 Amended Table S2 B811

Crop yields and productivity indices for optimum management (B811) are maintained at the following NRES web site: <http://soilproductivity.nres.illinois.edu/>

** Indexes adjusted for slope and erosion according to Bulletin 811 Table S3

Soils data provided by USDA and NRCS. Soils data provided by University of Illinois at Champaign-Urbana.