

Aerial Map

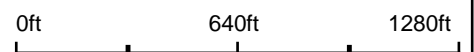

©2018 AgriData, Inc.

map center: 37° 46' 30.22, -89° 37' 58.86



2-9S-5W
Jackson County
Illinois



12/27/2018

Soils Map

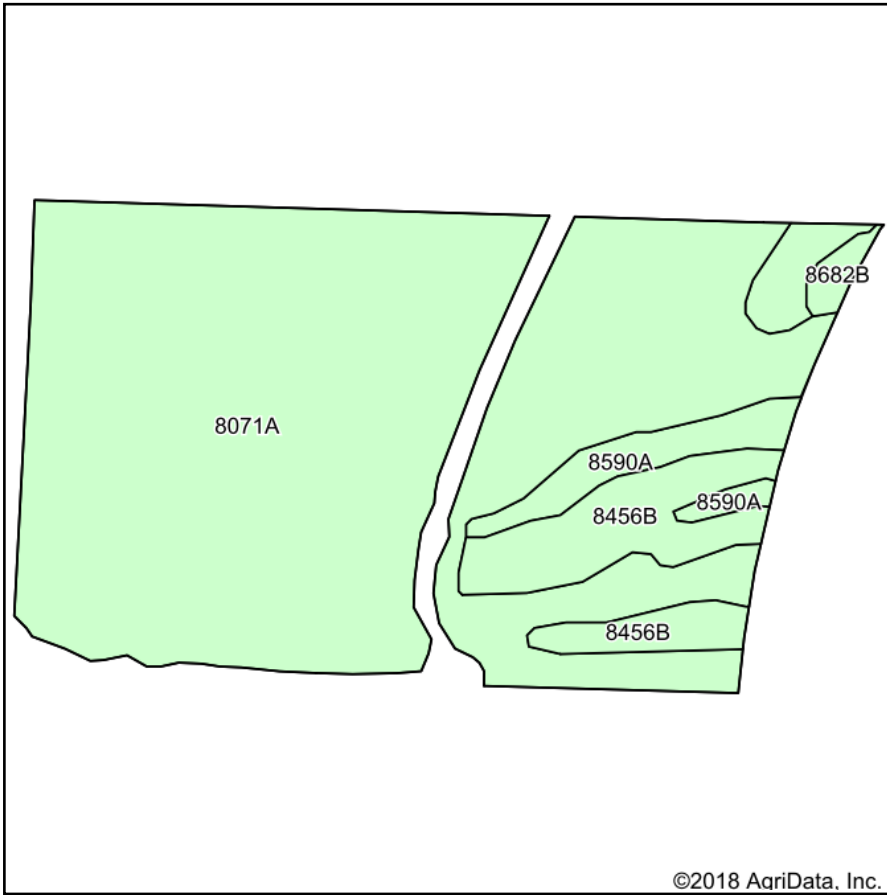

Soils data provided by USDA and NRCS.

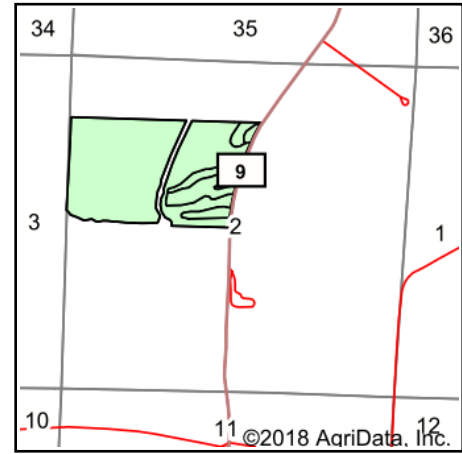

State: **Illinois**
 County: **Jackson**
 Location: **2-9S-5W**
 Township: **Degognia**
 Acres: **99.53**
 Date: **12/27/2018**



Maps Provided By:



© AgriData, Inc. 2018

www.AgridataInc.com



Area Symbol: IL077, Soil Area Version: 18

Code	Soil Description	Acres	Percent of field	Il. State Productivity Index Legend	Corn Bu/A	Soybeans Bu/A	Wheat Bu/A	Crop productivity index for optimum management
8071A	Darwin silty clay, 0 to 2 percent slopes, occasionally flooded	83.45	83.8%		149	50	60	111
8456B	Ware loam, 1 to 6 percent slopes, occasionally flooded	9.15	9.2%		159	51	63	118
8590A	Cairo silty clay, 0 to 2 percent slopes, occasionally flooded	6.06	6.1%		159	53	61	119
8682B	Medway silty clay loam, 1 to 6 percent slopes, occasionally flooded	0.87	0.9%		176	57	69	131
Weighted Average					150.8	50.3	60.4	112.3

Table: Optimum Crop Productivity Ratings for Illinois Soil by K.R. Olson and J.M. Lang, Office of Research, ACES, University of Illinois at Champaign-Urbana. Version: 1/2/2012 Amended Table S2 B811

Crop yields and productivity indices for optimum management (B811) are maintained at the following NRES web site: <http://soilproductivity.nres.illinois.edu/>

** Indexes adjusted for slope and erosion according to Bulletin 811 Table S3

Soils data provided by USDA and NRCS. Soils data provided by University of Illinois at Champaign-Urbana.