

# Aerial Map



©2018 AgriData, Inc.

map center: 37° 46' 34.57, -89° 36' 54.6

0ft 266ft 531ft



Maps Provided By:  
  
CUSTOMIZED ONLINE MAPPING  
© AgriData, Inc. 2018 www.AgriDataInc.com

**1-9S-5W**  
**Jackson County**  
**Illinois**



12/28/2018

# Soils Map

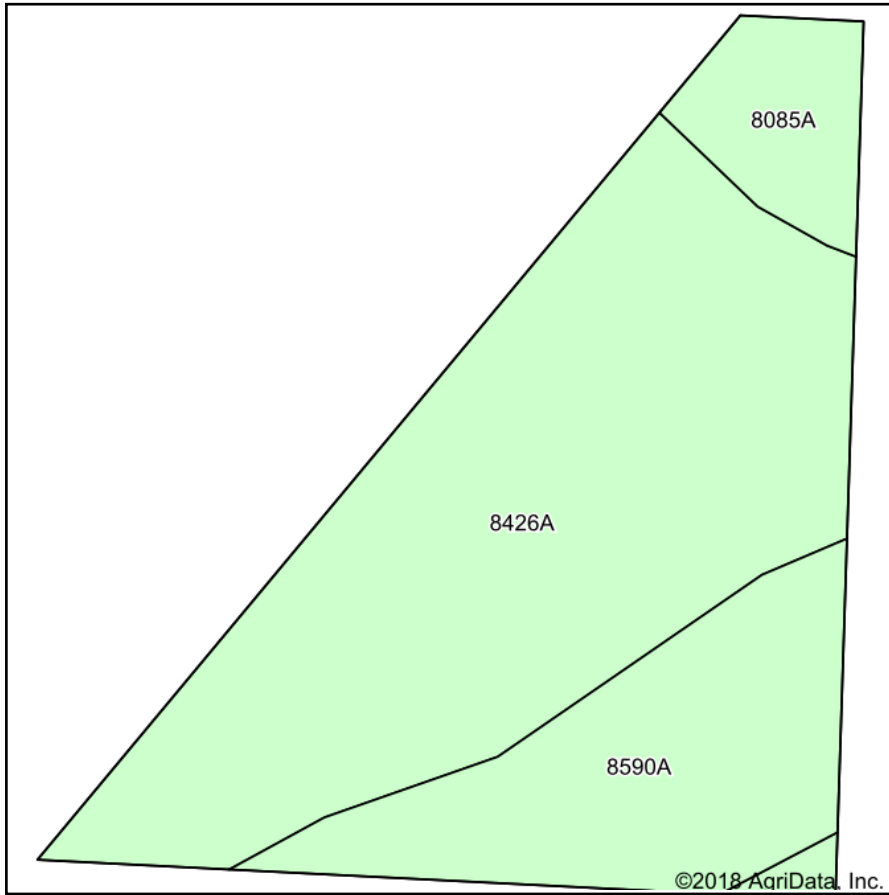

Soils data provided by USDA and NRCS.

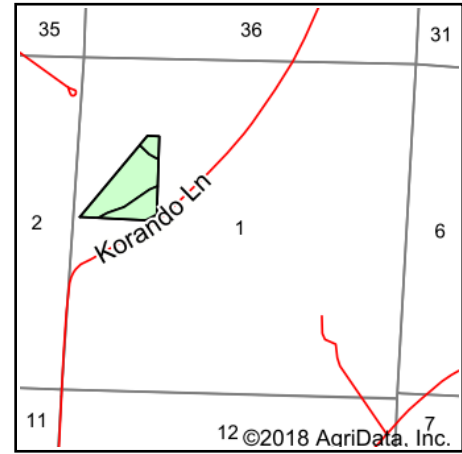

State: **Illinois**  
 County: **Jackson**  
 Location: **1-9S-5W**  
 Township: **Degognia**  
 Acres: **21.34**  
 Date: **12/28/2018**



Maps Provided By:



© AgriData, Inc. 2018

www.AgriDataInc.com



## Area Symbol: IL077, Soil Area Version: 18

Code	Soil Description	Acres	Percent of field	Il. State Productivity Index Legend	Corn Bu/A	Soybeans Bu/A	Wheat Bu/A	Crop productivity index for optimum management
8426A	Karnak silty clay, 0 to 2 percent slopes, occasionally flooded	14.12	66.2%		134	45	53	101
8590A	Cairo silty clay, 0 to 2 percent slopes, occasionally flooded	5.31	24.9%		159	53	61	119
8085A	Jacob silty clay, 0 to 2 percent slopes, occasionally flooded	1.70	8.0%		105	39	43	82
8682B	Medway silty clay loam, 1 to 6 percent slopes, occasionally flooded	0.21	1.0%		176	57	69	131
<b>Weighted Average</b>					<b>138.3</b>	<b>46.6</b>	<b>54.4</b>	<b>104.3</b>

**Table: Optimum Crop Productivity Ratings for Illinois Soil by K.R. Olson and J.M. Lang, Office of Research, ACES, University of Illinois at Champaign-Urbana.** Version: 1/2/2012 Amended Table S2 B811

Crop yields and productivity indices for optimum management (B811) are maintained at the following NRES web site: <http://soilproductivity.nres.illinois.edu/>

\*\* Indexes adjusted for slope and erosion according to Bulletin 811 Table S3

Soils data provided by USDA and NRCS. Soils data provided by University of Illinois at Champaign-Urbana.