

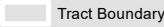

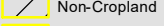
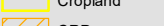
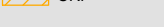

**Legend**

-  Tract Boundary
-  Non-Cropland
-  Cropland
-  CRP

**Wetland Determination Identifiers**

-  Restricted Use
-  Limited Restrictions
-  Exempt from Conservation
-  Compliance Provisions

**2024 Program Year**  
Map Created March 09, 2024

**Farm 4698**  
**Tract 256**

**Tract Cropland Total: 93.65 acres**

United States Department of Agriculture (USDA) Farm Service Agency (FSA) maps are for FSA Program administration only. This map does not represent a legal survey or reflect actual ownership; rather it depicts the information provided directly from the producer and/or National Agricultural Imagery Program (NAIP) imagery. The producer accepts the data 'as is' and assumes all risks associated with its use. USDA-FSA assumes no responsibility for actual or consequential damage incurred as a result of any user's reliance on this data outside FSA Programs. Wetland identifiers do not represent the size, shape, or specific determination of the area. Refer to your original determination (CPA-026 and attached maps) for exact boundaries and determinations or contact USDA Natural Resources Conservation Service (NRCS).

# Soils Map

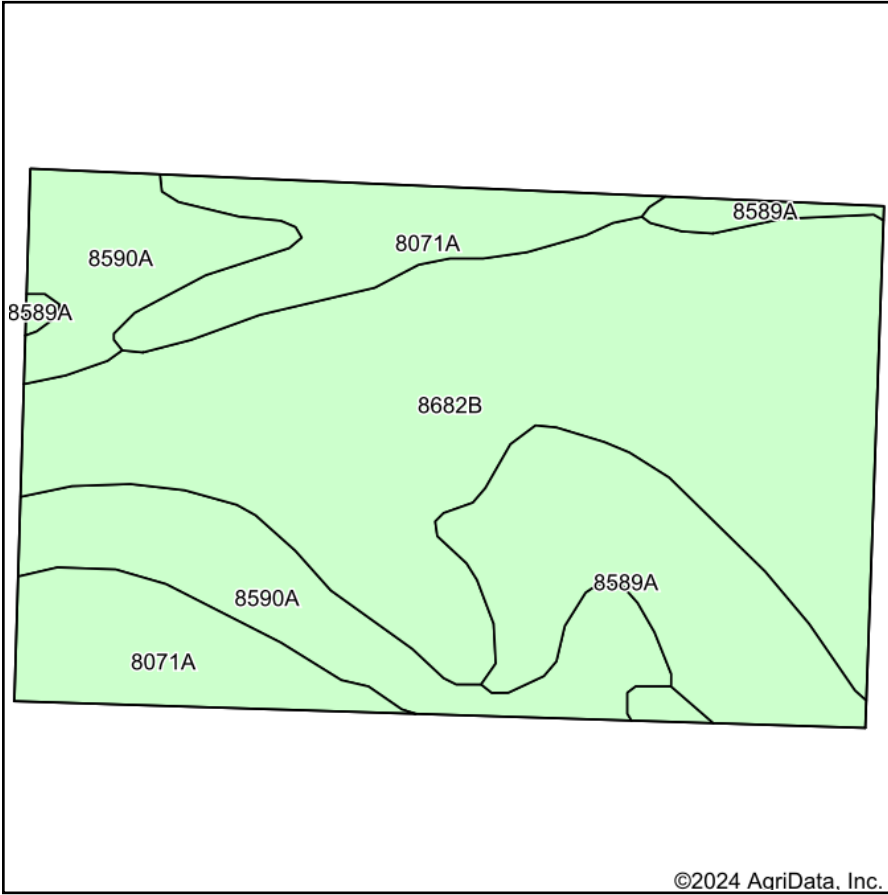

Soils data provided by USDA and NRCS.

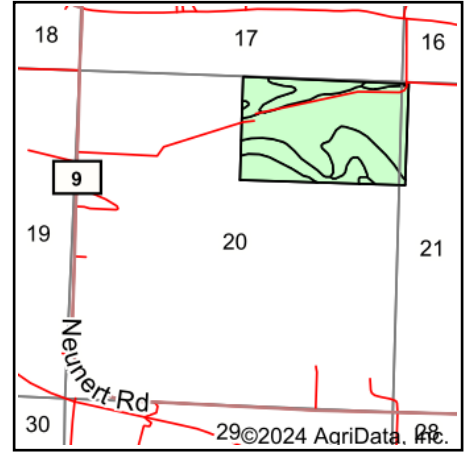

State: **Illinois**  
 County: **Jackson**  
 Location: **20-9S-4W**  
 Township: **Fountain Bluff**  
 Acres: **102.02**  
 Date: **9/6/2024**



Maps Provided By:



Area Symbol: IL077, Soil Area Version: 23

| Code                    | Soil Description  | Acres | Percent of field | Corn Bu/A    | Soybeans Bu/A | Wheat Bu/A  | Crop productivity index for optimum management | *n NCCPI Soybeans |
|-------------------------|---|-------|------------------|--------------|---------------|-------------|--|-------------------|
| **8682B                 | Medway silty clay loam, 1 to 6 percent slopes, occasionally flooded | 49.73 | 48.7%            | **172        | **56          | **68        | **128  | 69                |
| **8590A                 | Cairo silty clay, 0 to 2 percent slopes, occasionally flooded       | 18.81 | 18.4%            | **158        | **53          | **60        | **118  | 59                |
| **8071A                 | Darwin silty clay, 0 to 2 percent slopes, occasionally flooded      | 17.41 | 17.1%            | **148        | **50          | **60        | **111  | 46                |
| **8589A                 | Bowdre silty clay, 0 to 3 percent slopes, occasionally flooded      | 16.07 | 15.8%            | **150        | **47          | **57        | **110  | 75                |
| <b>Weighted Average</b> |   |       |                  | <b>161.9</b> | <b>53</b>     | <b>63.4</b> | <b>120.4</b>                                   | <b>*n 64.2</b>    |

**Table: Optimum Crop Productivity Ratings for Illinois Soil EFOTG are sourced from Bulletin 811 calculated Map Unit Base Yield Indices, and adjusted (Adj) for slope, erosion, flooding, and surface texture.** Publication Date: 02-08-2023

Crop yields and productivity (B811 EFOTG) are maintained at the following USDA web site: 2023 Illinois Soil Productivity and Yield Indices: <https://efotg.sc.egov.usda.gov/#/state/IL/documents/section=2&folder=52809>

\*\* Base indexes from Bulletin 811 adjusted for slope, erosion, flooding, and surface texture according to the II. Soils EFOTG

\*n: The aggregation method is "Weighted Average using all components"



# Topography Map

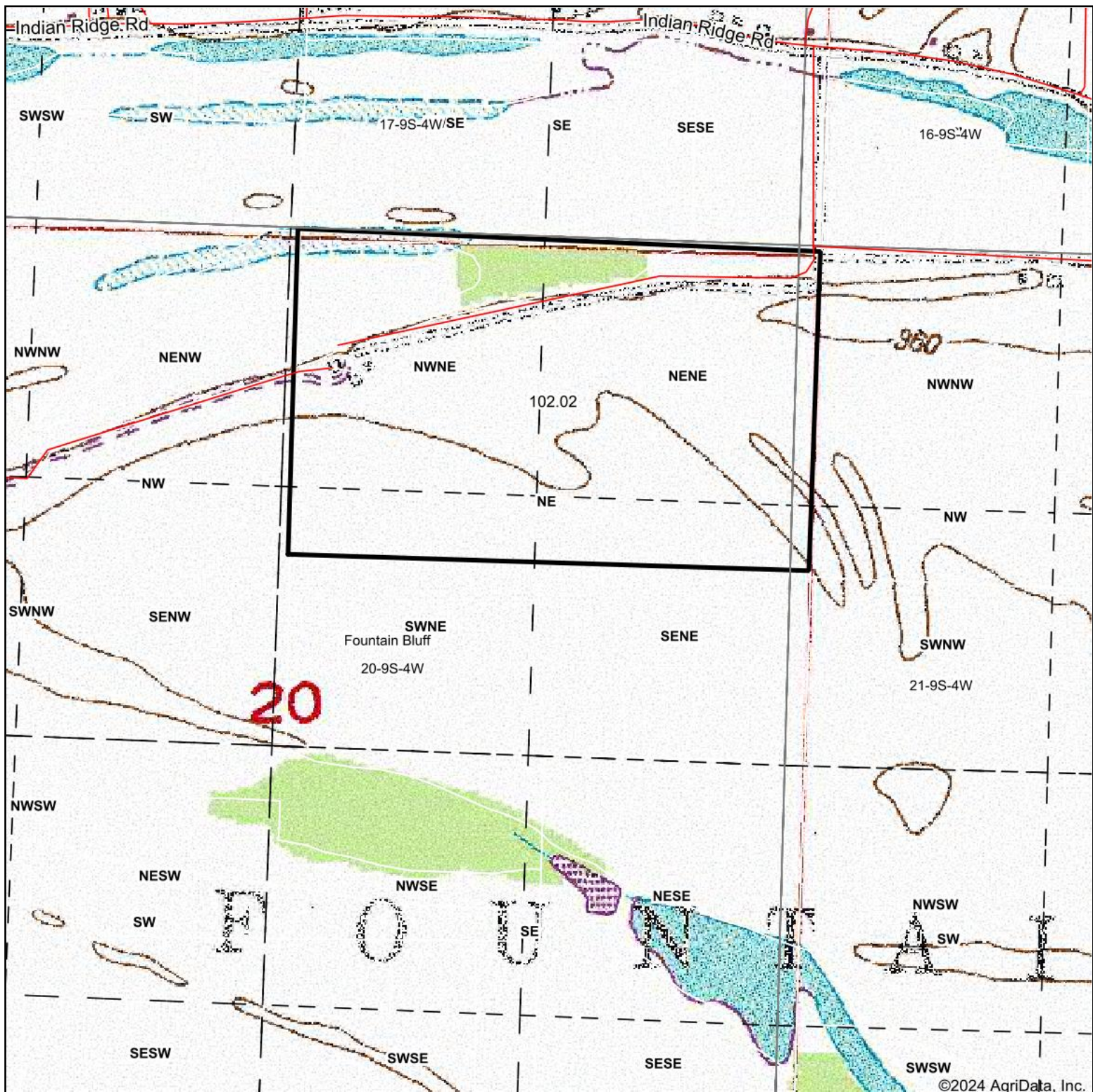

Map Center: 37° 43' 58.05, -89° 34' 8.27



Maps Provided By:



© AgriData, Inc. 2023

www.AgridataInc.com

**20-9S-4W**  
**Jackson County**  
**Illinois**



9/6/2024



**Abbreviated 156 Farm Record**

**Operator Name** : HEINS BROTHERS FARMS  
**CRP Contract Number(s)** : None  
**Recon ID** : 17-077-2011-13  
**Transferred From** : None  
**ARCPLC G//F Eligibility** : Eligible

**Farm Land Data**

| Farmland           | Cropland           | DCP Cropland           | WBP            | EWP  | WRP  | GRP  | Sugarcane            | Farm Status | Number Of Tracts |
|--------------------|--------------------|------------------------|----------------|------|------|------|----------------------|-------------|------------------|
| 182.09             | 170.96             | 171.56                 | 0.00           | 0.00 | 0.00 | 0.00 | 0.0                  | Active      | 2                |
| State Conservation | Other Conservation | Effective DCP Cropland | Double Cropped |      | CRP  | MPL  | DCP Ag.Rel. Activity | SOD         |                  |
| 0.00               | 0.00               | 171.56                 | 0.00           |      | 0.00 | 0.00 | 0.60                 | 0.00        |                  |

**Crop Election Choice**

| ARC Individual | ARC County  | Price Loss Coverage |
|----------------|-------------|---------------------|
| None           | CORN, SOYBN | None                |

**DCP Crop Data**

| Crop Name    | Base Acres    | CCC-505 CRP Reduction Acres | PLC Yield | HIP |
|--------------|---------------|-----------------------------|-----------|-----|
| Corn         | 42.06         | 0.00                        | 116       |     |
| Soybeans     | 122.04        | 0.00                        | 45        |     |
| <b>TOTAL</b> | <b>164.10</b> | <b>0.00</b>                 |           |     |

**NOTES**

|  |
|--|
|  |
|--|

**Tract Number** : 255

**Description** : C8-3 SEC 20 T9SR4W  
**FSA Physical Location** : ILLINOIS/JACKSON  
**ANSI Physical Location** : ILLINOIS/JACKSON  
**BIA Unit Range Number** :  
**HEL Status** : NHEL: No agricultural commodity planted on undetermined fields  
**Wetland Status** : Wetland determinations not complete  
**WL Violations** : None  
**Owners** : A & A HEINS FARM, BRENDA HELLMER-TODD, RONALD E HEINS, ROBERT L SUMNER  
**Other Producers** : None  
**Recon ID** : None

**Tract Land Data**

| Farm Land | Cropland | DCP Cropland | WBP  | EWP  | WRP  | GRP  | Sugarcane |
|-----------|----------|--------------|------|------|------|------|-----------|
| 80.03     | 77.31    | 77.91        | 0.00 | 0.00 | 0.00 | 0.00 | 0.0       |

**Abbreviated 156 Farm Record**

**Tract 255 Continued ...**

| State Conservation | Other Conservation | Effective DCP Cropland | Double Cropped | CRP  | MPL  | DCP Ag. Rel Activity | SOD  |
|--------------------|--------------------|------------------------|----------------|------|------|----------------------|------|
| 0.00               | 0.00               | 77.91                  | 0.00           | 0.00 | 0.00 | 0.60                 | 0.00 |

**DCP Crop Data**

| Crop Name    | Base Acres   | CCC-505 CRP Reduction Acres | PLC Yield |
|--------------|--------------|-----------------------------|-----------|
| Corn         | 19.10        | 0.00                        | 116       |
| Soybeans     | 55.42        | 0.00                        | 45        |
| <b>TOTAL</b> | <b>74.52</b> | <b>0.00</b>                 |           |

**NOTES**

**Tract Number : 256**

**Description :** C8-3 SEC 20 T9SR4W  
**FSA Physical Location :** ILLINOIS/JACKSON  
**ANSI Physical Location :** ILLINOIS/JACKSON  
**BIA Unit Range Number :**  
**HEL Status :** NHEL: No agricultural commodity planted on undetermined fields  
**Wetland Status :** Wetland determinations not complete  
**WL Violations :** None  
**Owners :** RONALD E HEINS, A & A HEINS FARM, BRENDA HELLMER-TODD, ROBERT L SUMNER  
**Other Producers :** None  
**Recon ID :** None

**Tract Land Data**

| Farm Land          | Cropland           | DCP Cropland           | WBP            | EWP  | WRP  | GRP                  | Sugarcane |
|--------------------|--------------------|------------------------|----------------|------|------|----------------------|-----------|
| 102.06             | 93.65              | 93.65                  | 0.00           | 0.00 | 0.00 | 0.00                 | 0.0       |
| State Conservation | Other Conservation | Effective DCP Cropland | Double Cropped | CRP  | MPL  | DCP Ag. Rel Activity | SOD       |
| 0.00               | 0.00               | 93.65                  | 0.00           | 0.00 | 0.00 | 0.00                 | 0.00      |

**DCP Crop Data**

| Crop Name    | Base Acres   | CCC-505 CRP Reduction Acres | PLC Yield |
|--------------|--------------|-----------------------------|-----------|
| Corn         | 22.96        | 0.00                        | 116       |
| Soybeans     | 66.62        | 0.00                        | 45        |
| <b>TOTAL</b> | <b>89.58</b> | <b>0.00</b>                 |           |

**NOTES**

ILLINOIS  
JACKSON

Form: FSA-156EZ



United States Department of Agriculture  
Farm Service Agency

## Abbreviated 156 Farm Record

FARM : 4698

Prepared : 9/6/24 11:10 AM CST

Crop Year : 2024

*In accordance with Federal civil rights law and U.S. Department of Agriculture (USDA) civil rights regulations and policies, the USDA, its Agencies, offices, and employees, and institutions participating in or administering USDA programs are prohibited from discriminating based on race, color, national origin, religion, sex, gender identity (including gender expression), sexual orientation, disability, age, marital status, family/parental status, income derived from a public assistance program, political beliefs, or reprisal or retaliation for prior civil rights activity, in any program or activity conducted or funded by USDA (not all bases apply to all programs). Remedies and complaint filing deadlines vary by program or incident.*

*Persons with disabilities who require alternative means of communication for program information (e.g., Braille, large print, audiotape, American Sign Language, etc.) should contact the responsible Agency or USDA's TARGET Center at (202) 720-2600 (voice and TTY) or contact USDA through the Federal Relay Service at (800) 877-8339. Additionally, program information may be made available in languages other than English.*

*To file a program discrimination complaint, complete the USDA Program Discrimination Complaint Form, AD-3027, found online at [http://www.ascr.usda.gov/complaint\\_filing\\_cust.html](http://www.ascr.usda.gov/complaint_filing_cust.html) and at any USDA office or write a letter addressed to USDA and provide in the letter all of the information requested in the form. To request a copy of the complaint form, call (866) 632-9992. Submit your completed form or letter to USDA by: (1) mail: U.S. Department of Agriculture Office of the Assistant Secretary for Civil Rights 1400 Independence Avenue, SW Washington, D.C. 20250-9410; (2) fax: (202) 690-7442; or (3) e-mail: [program.intake@usda.gov](mailto:program.intake@usda.gov). USDA is an equal opportunity provider, employer, and lender.*