

Aerial Map



Boundary Center: 37° 44' 26.08, -88° 29' 36.62



13-9S-6E
Saline County
Illinois



Maps Provided By:



© AgriData, Inc. 2023 www.AgriDataInc.com

9/18/2024

Field borders provided by Farm Service Agency as of 5/21/2008.

Aerial Map



©2024 AgriData, Inc.

Boundary Center: 37° 44' 26.08, -88° 29' 36.62



13-9S-6E
Saline County
Illinois



9/18/2024



Maps Provided By:



© AgriData, Inc. 2023 www.AgriDataInc.com

Field borders provided by Farm Service Agency as of 5/21/2008.

Aerial Map



©2024 AgriData, Inc.

Boundary Center: 37° 44' 26.08, -88° 29' 36.62



13-9S-6E
Saline County
Illinois



Maps Provided By:
surety
CUSTOMIZED ONLINE MAPPING
© AgriData, Inc. 2023 www.AgriDataInc.com

9/18/2024

Field borders provided by Farm Service Agency as of 5/21/2008.

Aerial Map



©2024 AgriData, Inc.

Boundary Center: 37° 44' 26.08, -88° 29' 36.62



13-9S-6E
Saline County
Illinois



9/18/2024



Maps Provided By:



© AgriData, Inc. 2023 www.AgriDataInc.com

Field borders provided by Farm Service Agency as of 5/21/2008.

Topography Contours



©2024 AgriData, Inc.



Maps Provided By:



© AgriData, Inc. 2023 www.AgriDataInc.com

Source: USGS 1 meter dem
 Interval(ft): 2.0
 Min: 358.2
 Max: 361.2
 Range: 3.0
 Average: 360.3
 Standard Deviation: 0.33 ft

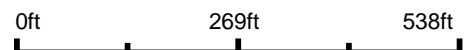

9/18/2024

13-9S-6E
Saline County
Illinois

Boundary Center: 37° 44' 26.08, -88° 29' 36.62

Field borders provided by Farm Service Agency as of 5/21/2008.

Topography Hillshade



©2024 AgriData, Inc.

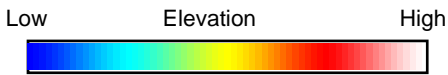

Source: USGS 1 meter dem
 Interval(ft): 2
 Min: 358.2
 Max: 361.2
 Range: 3.0
 Average: 360.3
 Standard Deviation: 0.33 ft

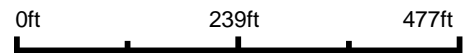

13-9S-6E
Saline County
Illinois

Boundary Center: 37° 44' 26.08, -88° 29' 36.62



Maps Provided By:



© AgriData, Inc. 2023 www.AgriDataInc.com

Field borders provided by Farm Service Agency as of 5/21/2008.

Wetlands Map

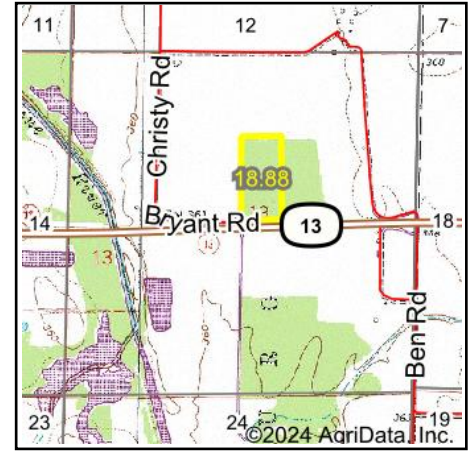

State: Illinois
Location: 13-9S-6E
County: Saline
Township: Harrisburg
Date: 9/18/2024



Maps Provided By:



© AgriData, Inc. 2023 www.AgriDataInc.com



0ft 391ft 782ft

Classification Code	Type	Acres
PFO1C	Freshwater Forested/Shrub Wetland	17.11
PFO1A	Freshwater Forested/Shrub Wetland	0.00
Total Acres		17.11

Data Source: National Wetlands Inventory website. U.S. Dol, Fish and Wildlife Service, Washington, D.C. <http://www.fws.gov/wetlands/>